

IMPRESSION

FOREST RIVER



IMPRESSIONRV.COM

FLOORPLANS

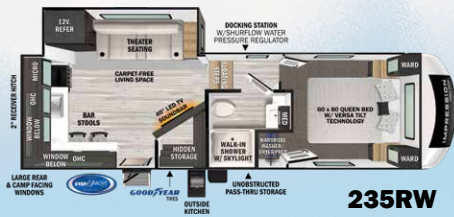

235RW



240RE

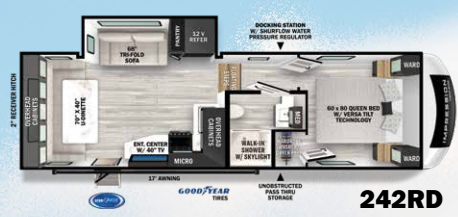

242RD



270RK

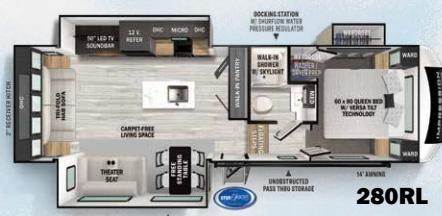

280RL



290VB

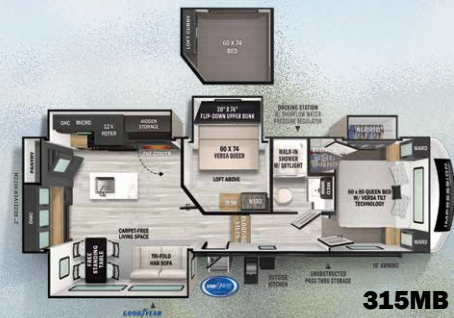

315MB

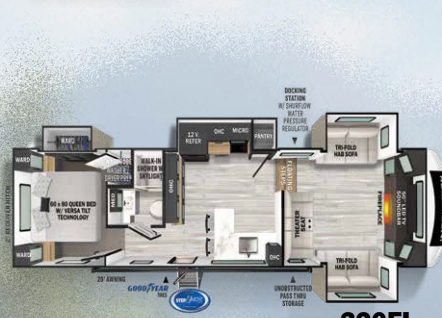

320FL



330BH

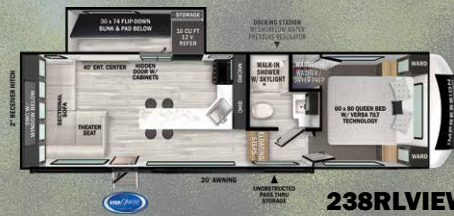

238RLVIEW

New



282RLVIEW

New

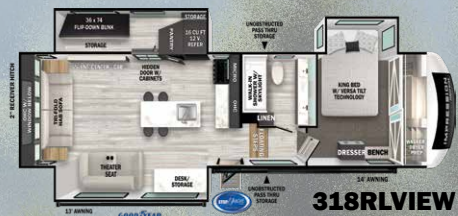

318RLVIEW

New

SPECIFICATIONS	235RW	240RE	242RD	270RK	280RL	290VB	315MB	320FL	330BH	238RLVIEW	282RLVIEW	318RLVIEW
LENGTH	28' 11"	31' 0"	30' 5"	34' 6"	35' 3"	36' 8"	38' 0"	40' 2"	41' 0"	31' 3"	35' 1"	38' 11"
HEIGHT	13' 2"	13' 2"	12' 10"	13' 2"	13' 2"	13' 2"	13' 2"	13' 4"	13' 4"	TBD	13' 2"	13' 2"
HITCH WEIGHT	1,460 LB.	1,350 LB.	1,485 LB.	1,515 LB.	1,825 LB.	1,755 LB.	1,935 LB.	2,535 LB.	2,280 LB.	TBD	1,852 LB.	2,037 LB.
UVW	7,538 LB.	8,243 LB.	7,568 LB.	8,948 LB.	9,549 LB.	8,623 LB.	10,338 LB.	10,303 LB.	10,753 LB.	TBD	9,332 LB.	11,078 LB.
CCC	4,122 LB.	3,307 LB.	2,427 LB.	2,767 LB.	2,476 LB.	3,332 LB.	3,597 LB.	4,232 LB.	3,527 LB.	TBD	2,702 LB.	2,967 LB.
FRESH WATER	57 GAL.	57 GAL.	57 GAL.	57 GAL.	57 GAL.	57 GAL.	57 GAL.	57 GAL.	57 GAL.	TBD	57 GAL.	57 GAL.
GREY WATER	60 GAL.	60 GAL.	30 GAL.	62 GAL.	60 GAL.	62 GAL.	62 GAL.	60 GAL.	60 GAL.	TBD	60 GAL.	60 GAL.
BLACK WATER	30 GAL.	30 GAL.	32 GAL.	30 GAL.	30 GAL.	30 GAL.	30 GAL.	30 GAL.	62 GAL.	TBD	30 GAL.	30 GAL.
AWNING	20'	16'	17'	14'	14'	18'	18'	20'	12' & 14'	TBD	24'	13' & 14'

EXTERIOR FEATURES

- Upgraded E-Rated Goodyear Endurance Tires (Made In the U.S.A.)
- One Touch Automatic Leveling System (*Model Specific*)
- Gel Coat Fiberglass Front Cap with Automotive Windshield & LED Lights
- Shurflo Water Pressure Regulator
- Enclosed Docking Station
- Black Tank Flush, Winterization & Sanitation
- Enclosed Tank Valves
- Outside Shower
- Easy Access Water Heater Bypass
- Off Grid Package: 100W Roof Panel, 30 AMP Charge Controller, Battery
- Morryde Step Above Entry Steps
- 2" Accessory Hitch w/3,000 lb. Towing Capability
- Enclosed Spare Tire & Carrier (Full Size)
- Insulated Exterior Slam Latch Baggage Door
- Battery Disconnect in Pass-Through
- Custom Aluminum Rims
- Marine Grade Outdoor Speakers
- Factory Installed Roof Ladder
- Observation Back Up Camera Prep
- Adjustable Power Awning with LED Lights
- Slide Topper/Awning Prep
- 60K BTU On Demand Water Heater
- 30" Friction Hinge Entry Door
- Detachable Power Cord
- LED Exterior Lighting
- Custom Exterior Graphics Package

INTERIOR FEATURES

- Blackout Curtains & Roller Shades with Reflective Back
- Lumbercore Cabinetry
- Ductless Flooring Throughout for Easy Sweeping
- Centralized Command Center with Built-In Tank Monitoring System
- USB Charging Stations
- WiFi Prep, Digital TV Antenna
- Full Extension Drawer Glides
- Residential Linoleum
- Residential Carpet with Stain Guard Protection
- Flex Pex Plumbing
- Carbon Monoxide/LP Detector
- LED Interior Lighting Throughout

KITCHEN FEATURES

- 10 CU FT 12V Refrigerator
- Glass Recessed Range with Glass Cover
- Glass Microwave with Exhaust Vent
- Residential Backsplash
- Stainless Steel Single Bowl Sink
- High Rise Faucet with Pull-Down Sprayer

- Floor To Ceiling Pantry
- Natural Lighting From Skylight

LIVING ROOM FEATURES

- Carpet-Free Living Space
- Living Room LED TV (50" or 40")
- Electric Fireplace/Space Heater (5,500 Watt Heats up to 400 sq. ft.) (N/A 242RD)
- Dual Zone Soundbar
- Oversized Opening Windows
- Trifold Hide A Bed with Residential Sleep Surface
- Theater Seating with USB Charge Ports (*Model Specific*)
- Free Standing Table w/ 4 Chairs Standard (N/A 235RW, 242RD, 320FL, & VIEW series)
- 2 Barstools (235RW, 320FL)
- Booth Dinette (242RD)

BATHROOM FEATURES

- Porcelain Foot Flush Toilet
- Walk-In Shower with Skylight
- Anti-Bacterial Shower Door
- Large Medicine Cabinet with Mirror

BEDROOM FEATURES

- Versa-Tilt Automated Bed Inclinor
- Full Size Stackable Washer/Dryer Prep
- 6'3" Bedroom Height
- 60" x 80" Mattress with Residential
- Residential Carpet with Stain Guard Protection
- Bedspread & Pillows
- Gas Strut Assisted Bed Lift with Storage
- Directional & Closable A/C Vents
- 110 Outlet & 12V Charging Ports Beside Bed
- CPAP Machine Ready
- Cable/Sat Prep

HEATING & COOLING

- Industry Leading 15K A/C Standard
- 35K BTU Furnace
- Maximixed A/C Ducting for Best Cooling Efficiency
- 12V Heat Pads For Holding Tanks
- Fully Heated & Enclosed AccessiBelly (Removable Underbelly Panels)
- Enclosed Tank Valves

CONSTRUCTION

- Vacuum Bonded Aluminum Structure with Azdel Panels
- Laminated Aluminum Front Wall
- Laminated Aluminum Sidewalls
- Laminated Aluminum Slide Boxes
- Laminated Aluminum Floor
- 5" Truss Rafters 16" OC
- One-Piece Tufflex™ PVC Roofing

- LCI Space Saver Upper Deck™ & LCI Rhino Box™ Frame
- Construction Additional Steel in Upper Deck (Vertical Tubular Frame for Strength, Additional Gussets increase Headroom in Bedroom)
- 100% PDI: Quality Inspection Check Points Throughout the Production Process. Before Any Unit Is Shipped from the Assembly Line to Our Dealer Partners, it Goes Through a Separate Stand-Alone Inspection

LUXURY PACKAGE

- Power Landing Gear & Stabilizer Jacks
- Upgraded E-Rated Goodyear Tires
- 60K BTU On Demand Water Heater
- Shurflo Water Pressure Regulator
- Oversized Tinted Opening Windows
- 10 CU FT 12V Refrigerator
- 2" Accessory Hitch w/3,000 lb. Towing Capability (N/A 320FL)
- Gel Coat Fiberglass Front Cap with Automotive Windshield (*Model Specific*)
- LED TV
- Morryde Step Above Entry Steps
- Exterior Slam Latch Door
- Outside Shower

COMFORT PACKAGE

- Superior Insulation with Astrofoil
- 12V Tank Heat Pads
- Forced Heat AccessiBelly
- Enclosed Tank Valves
- 35K BTU Furnace
- Industry Leading 15K A/C
- 50AMP with 2nd A/C Prep & W/D Prep

OFF GRID PACKAGE

- 30 AMP Charge Controller
- 100W Roof Panel
- Solar on Side Prep
- Battery

OPTIONS

- 4 Point Auto Level Mandatory (Model Specific)
- 2nd 13.5K Ducted A/C
- 8 CU FT Gas/Elec Refrigerator IPO 12V
- 10 CU FT Refrigerator
- Booth Dinette (N/A 235RW)

STANDARD ON 238RLVIEW, 282RLVIEW, & 318RLVIEW

- Maximum Window Coverage
- 16 CU FT 12V Refrigerator
- 1.6 CU FT Microwave
- Solid Surface Countertops
- Barstool Seating

Values subject to change. Check website for the most up-to-date specifications.





315MB HIDDEN PANTRY STORAGE



242RD



242RD



PRE-DELIVERY INSPECTION FACILITY

20,000 square feet of quality assurance. The bare essentials for a premium product. This state-of-the-art facility gives immediate daily feedback to production for quality assurance in every unit built.

CUSTOMER SATISFACTION



www.ForestRiverBuyLocal.com

Download our Forest River mobile app or visit our dynamic online manual to enhance your ownership experience. These interactive options provide incredible ease and insight into use, maintenance and enjoyment of your Forest River product.

Ranging from "How-To" videos, pictures and illustrations of various components, systems and features, to fully searchable content and downloadable PDFs for individual component owner's manuals, answers are always just a click away. View the online manual at www.forestriverinc.com/OnlineManual or download our FREE app from the App Store or Google Play!



FREE MEMBERSHIP
to Forest River Owners' Group

www.forestriverfrog.com



GVWR (Gross Vehicle Weight Rating) - is the maximum permissible weight of the unit when fully loaded. It includes all weights, inclusive of all fluids, cargo, optional equipment and accessories. For safety and product performance do NOT exceed the GVWR.

GAWR (Gross Axle Weight Rating) - is the maximum permissible weight, including cargo, fluids, optional equipment and accessories that can be safely supported by a combination of all axles.

UVW (Unloaded Vehicle Weight)** - is the typical weight of the unit as manufactured at the factory. It includes all weight at the unit's axle(s) and tongue or pin and LP Gas. The UVW does not include cargo, fresh potable water, additional optional equipment or dealer installed accessories.

CCC (Cargo Carrying Capacity)** - is the amount of weight available for fresh potable water, cargo, additional optional equipment and accessories. CCC is equal to GVWR minus UVW. Available CCC should accommodate fresh potable water (8.3 lbs per gallon). Before filling the fresh water tank, empty black and gray tanks for more cargo capacity.

*Estimated Average based on standard build optional equipment. ** Estimated average based on standard build optional equipment. Values estimated at time of printing.

Each Forest River RV is weighed at the manufacturing facility prior to shipping. A label identifying the unloaded vehicle weight of the actual unit and the cargo carrying capacity is applied to every Forest River RV prior to leaving our facilities. The load capacity of your unit is designated by weight, not by volume, so you cannot necessarily use all available space when loading your unit.

All information contained in this brochure is believed to be accurate at the time of publication. However, during the model year, it may be necessary to make revisions and Forest River, Inc., reserves the right to make all such changes without notice, including prices, colors, materials, equipment and specifications as well as the addition of new models and the discontinuance of models shown in this brochure. Therefore, please consult with your Forest River, Inc., dealer and confirm the existence of any materials, design or specifications that are material to your purchase decision.

©2023 Impression, a division of Forest River Inc., a Berkshire Hathaway company.



Learn More
Scan this barcode using a QR Reader on your smart phone to learn more about Forest River.



A Berkshire Hathaway company.



**24/7 EMERGENCY
ROADSIDE ASSISTANCE**
WITH VEHICLE PURCHASE***

TOWING
JUMP-STARTS
TIRE CHANGES
FLUID DELIVERY
LOCKOUT
SERVICE

WINCH-OUT
MOBILE MECHANIC
TECHNICAL
SUPPORT
DEALER LOCATOR
SERVICES



*VALID FOR 1 YEAR FROM DATE OF PURCHASE

**Starting January 1, 2024